

Polar[®] Focus

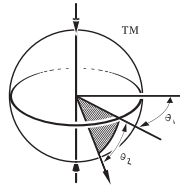

Audio Rigging Products

Zbeam[®] Wall Mount WM-2226-250

The patent pending all steel WM-2226-250 Zbeam[®] Wall Mount is intended as a companion to the Zbeam[®], allowing for almost any Zbeam[®] compatible speaker to be wall mounted. This product is specifically designed to match the standard pattern in 16"x8"x8" masonry block walls for easy through bolting. This unit can also be mounted to solid concrete walls using expansion bolts, or mounted to structural wood stud or steel stud walls by through bolting with simple plywood wall reinforcement. A mounted Zbeam[®] has a total of 7-1/2" of adjustability in moving away from the wall for larger speakers, or towards the wall for smaller speakers (fig. 4).

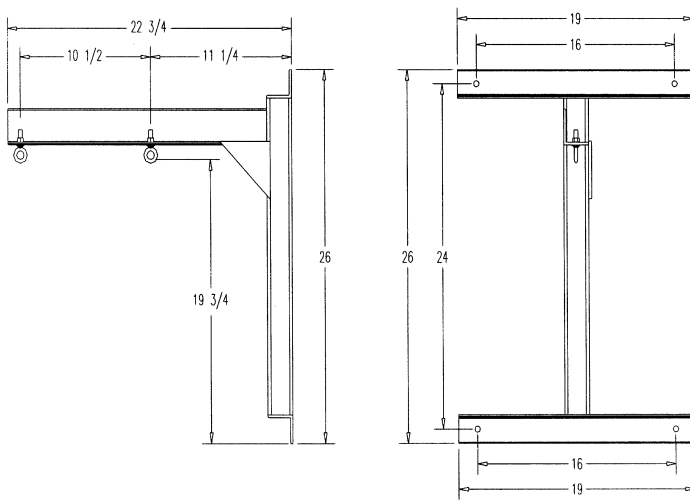

Figure 1. The Zbeam[®] Wall Mount.

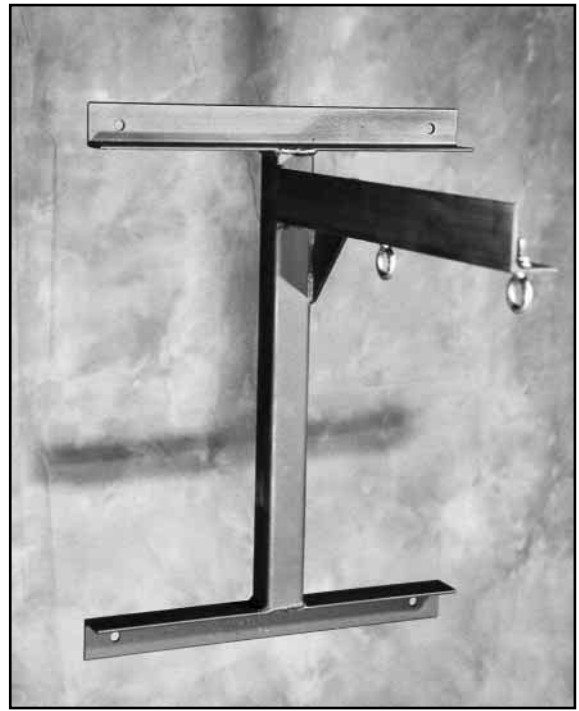

Figure 2. The Zbeam[®] Wall Mount.

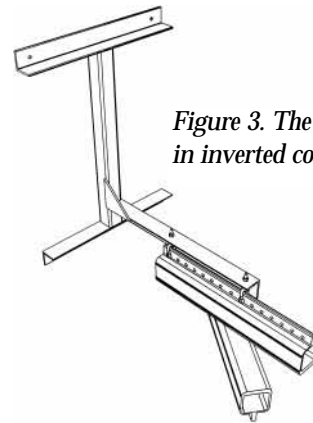

Figure 3. The Zbeam[®] Wall Mount in inverted configuration.

By reversing the eyebolt hardware on the WM-2226-250, the unit may be installed upside down if required (fig.3). This upside down application can be especially useful for installing the WM-2226-250 in crowded plenum spaces.

Alternate Applications: Wall mounting of large video screen boxes, wall mounting of traveler tracks for theatrical draperies.

Welding performed by AWS certified welders. Minimum 10:1 design factor to yield strength. Finish is flat black paint. Mounting instructions and two 5/16" shackles are included. Mounting hardware and Zbeam[®] not included.

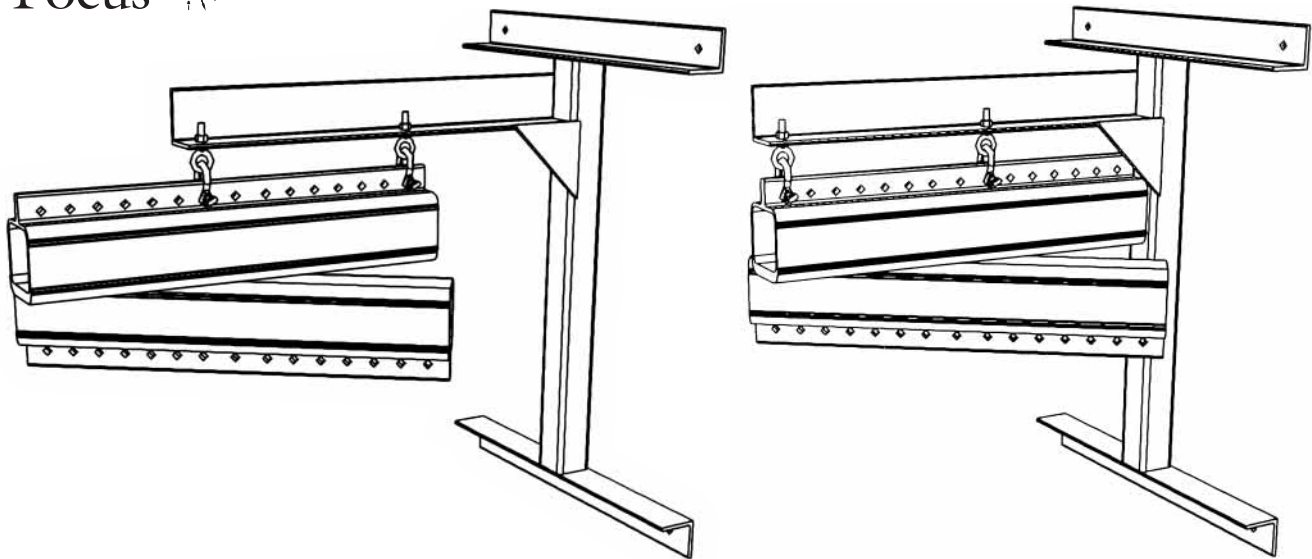

Figure 4. A Zbeam® in fully extended (left) and fully retracted (right) positions on a Zbeam® Wall Mount.

Architectural Specification:

The loudspeaker load shall be carried by the wall with the use of a welded steel bracket. The bracket shall be manufactured from structural steel, welded by an AWS certified welder. The bracket shall have a working load limit of 250 lbs with a 10:1 design factor to yield strength. The bracket shall have two $\frac{5}{16}$ " forged shoulder eyes separated by $10\frac{1}{2}$ " to support a Zbeam® rotary spreader beam. The bracket shall allow for $7\frac{1}{2}$ " of speaker adjustment towards or away from the wall. The bracket shall have a 16" wide by 24" high mounting pattern to match the standard layout of 16"x8"x8" masonry block walls. The bracket shall be designed to allow for upright or inverted use. The wall mount shall be the WM-2226-250 Zbeam® Wall Mount.

Overall length projecting from wall: 22.75" (577 mm)
overall height: 26" (660 mm)
overall width: 19" (482 mm)
weight: 18.8 lbs (8.5 kg)
shipping weight: 27.1 lbs (12.3 kg)
structural material: steel
finish: flat black paint
Working Load Limit (WLL): 250 lbs (113 kg)